

PC TYPE

– Pre-Cut Slide Shafts –

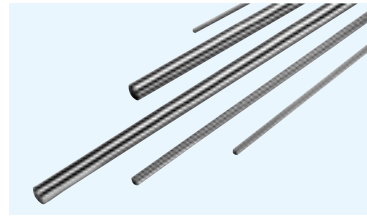

part number structure

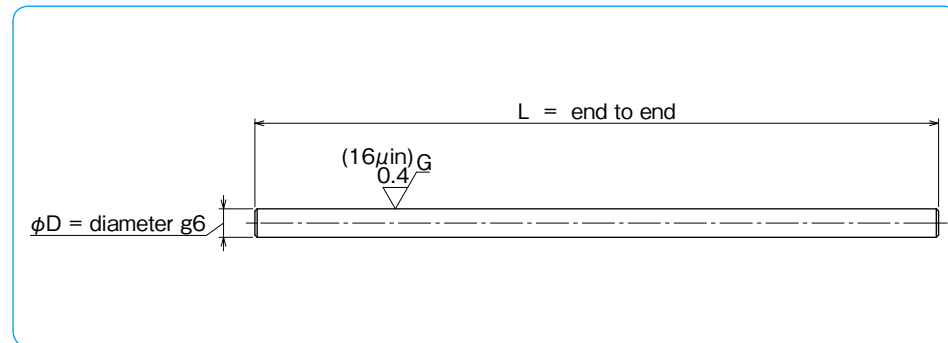
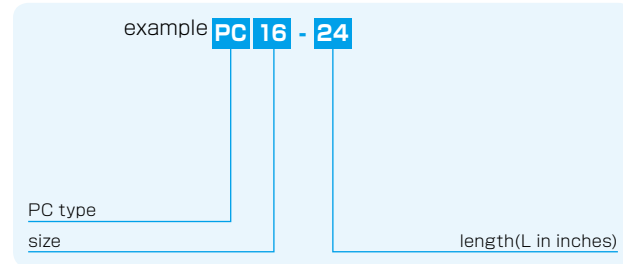

Part Number	Outer Diameter		Length L							Mass lbs/inch kg/m	
	D inch/mm	g6 inch/mm	inch mm								
PC 4	1/4	-.0002	6	12	18	24				0.014	
	6.350	-.0006	152.4	304.8	457.2	609.6				0.25	
PC 6	3/8	-5	6	12	18	24				0.031	
	9.525	-14	152.4	304.8	457.2	609.6				0.56	
PC 8	1/2	-.0002		12	18	24	30	36		0.056	
	12.700	-.0007		304.8	457.2	609.6	762	914.4		0.99	
PC 10	5/8	-6		12	18	24	30	36		0.086	
	15.875	-17		304.8	457.2	609.6	762	914.4		1.55	
PC 12	3/4	-.0003			18	24	30	36	42	48	0.125
	19.050	-.0008			457.2	609.6	762	914.4	1066.8	1219.2	2.24
PC 16	1	-7			18	24	30	36	42	48	0.222
	25.400	-20			457.2	609.6	762	914.4	1066.8	1219.2	3.98
PC 20	1-1/4	-.0004			18	24	30	36	42	48	0.348
	31.750	-.0010			457.2	609.6	762	914.4	1066.8	1219.2	6.22
PC 24	1-1/2	-9			18	24		36		48	0.500
	38.100	-25			457.2	609.6		914.4		1219.2	8.95

material: Equivalent to SUJ2
 hardness: 60 HRC or more
 tolerances: g6 or to be specified
 Product of NB Corporation of America

SPINDLE SHAFT & SPINDLE UNIT

NB Spindle Shaft is back by decades of precision manufacturing experience as well as up to date manufacturing facility to meet the demands. NB is capable of handling all your spindle needs such as manufacturing of bearing case and spindle base, design and manufacturing of spindle unit, and overhauling of spindles.

ADVANTAGES

Spindle Unit

NB provides overhauling, engineering services as well as manufacturing of spindle unit.

Ultra Precision Machining

Spindle manufacturing facility is controlled to a constant temperature throughout the year for precision manufacturing of spindles.

Various Machining Solution Available

BT, BBT, HSK inner tapers, gauge and bearing matching, thread grinding, and many other spindle related machining are available.

Surface Treatments

Various surface treatments are available such as hard chrome and ceramic coating. Repairing a damaged spindle with replating and grinding is also available.

EXAMPLE OF SPINDLE UNIT DESIGN AND MACHINING



Example of spindle unit specification	
Machine used	Machining center
Mounting orientation	Vertical
Rotational Speed	Max. 10,000 rpm (Max. 700 rpm without tooling attached)
Spindle taper size	#30
Lubrication methods	Grease lubrication
Lubricant	ISOFLEX NBU15 (NOK Corporation)
Tool clamping power	400 kgf (theoretical)
Estimated drive power	3.5kW
Estimated weight	31kg

EXAMPLES OF MACHINING

Spindle

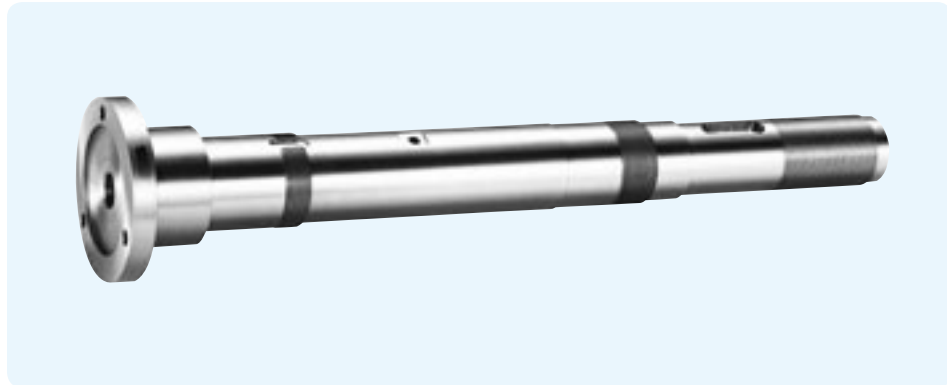
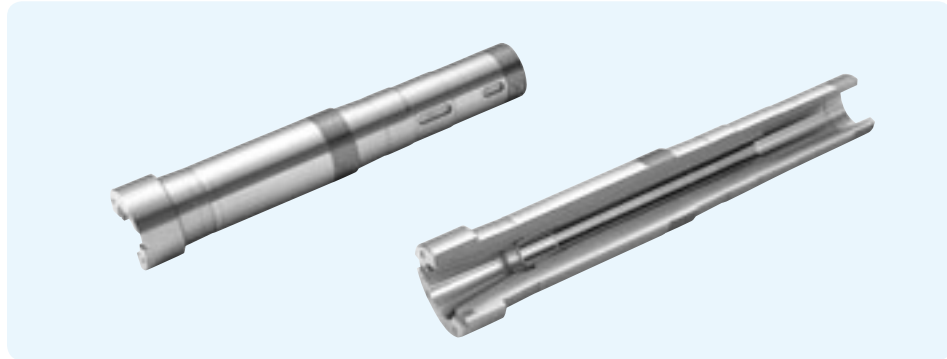
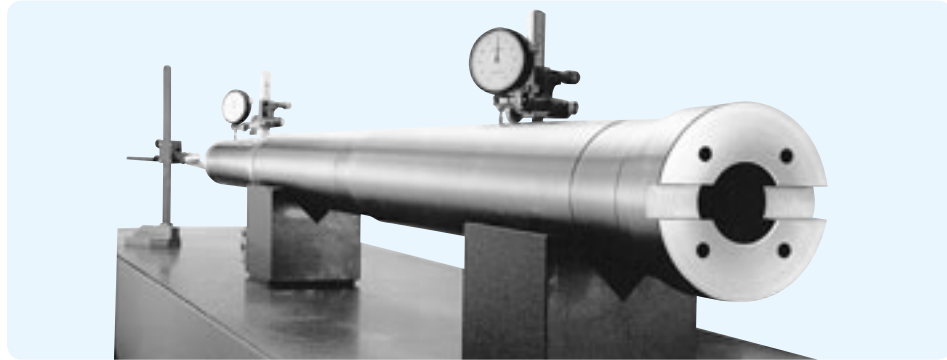

EXAMPLE OF DRAWING ①

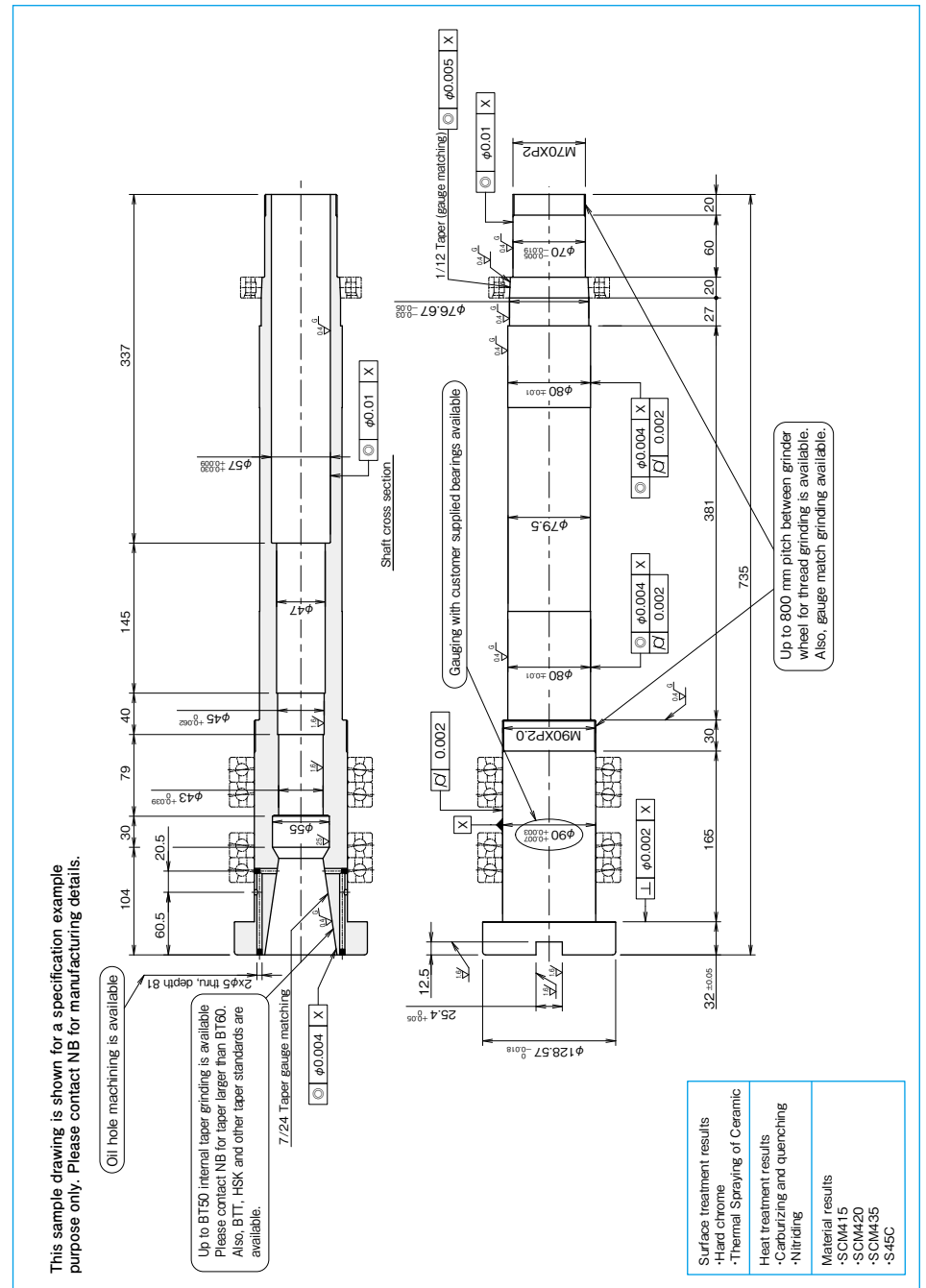

EXAMPLE OF DRAWING ②

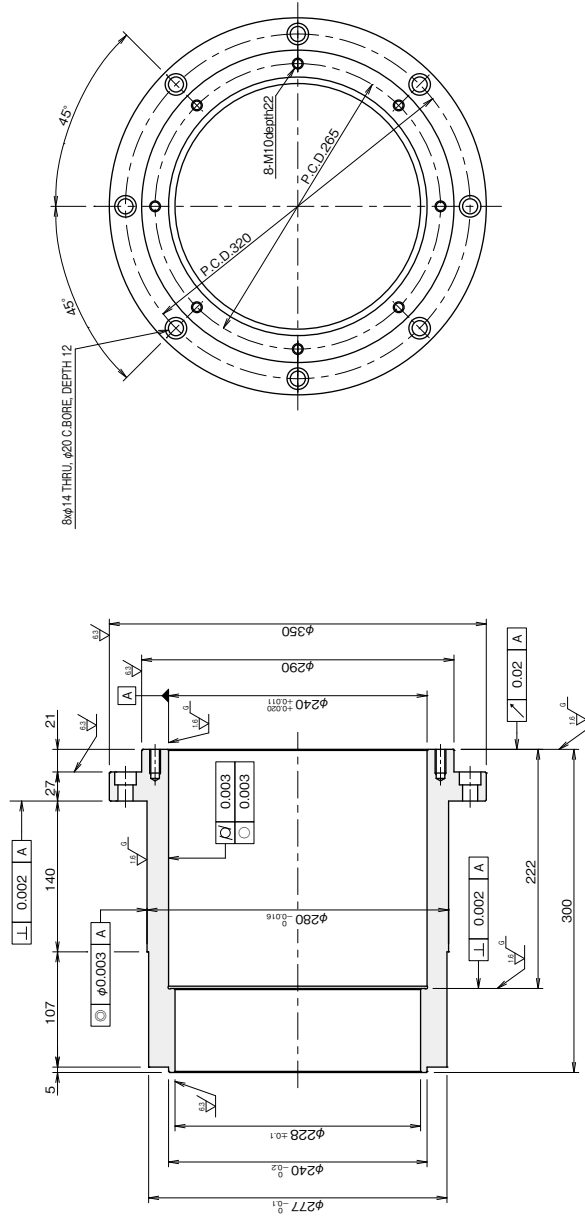

Material results
-S45C
-SCM435

This sample drawing is shown for a specification example purpose only. Please contact NB for manufacturing details.

EXAMPLE OF DRAWING ③

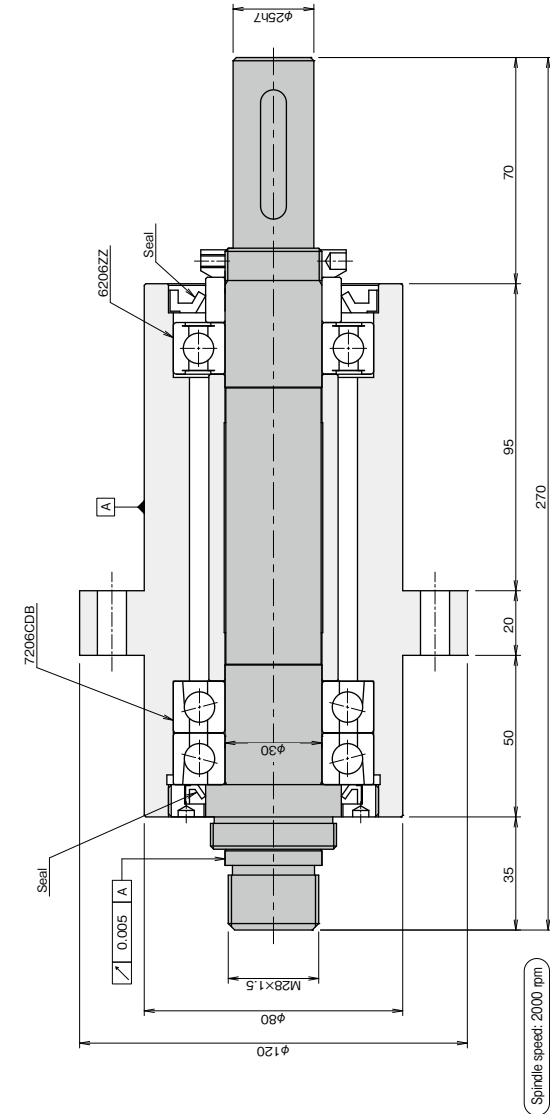

Spindle speed: 2000 rpm

This sample drawing is shown for a specification example purpose only. Please contact NB for manufacturing details.

Custom design and manufacturing service for various spindle units is available. Please contact NB for details.