

# SGW-TE TYPE

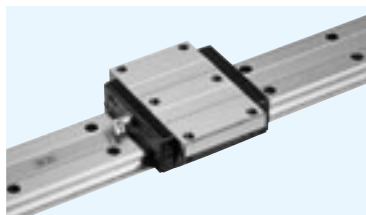

## part number structure

example **SGW21TEB2T1-589P/W2FSLBFKGL**

SGW type	TE typeblock	seal (refer to page A-14)	number of blocks attached to one rail	preload symbol	total length of rail	accuracy grade	symbol for grease	with rail mounting hole caps	with low temperature black chrome treatment	with Fiber Sheet	symbol for number of axes*
blank: with side-seals	blank: standard	blank: with side-seals + under-seals	blank: standard	blank: standard	blank: standard	blank: standard	blank: standard grease	blank: standard	blank: standard	blank: standard	blank: single axis
B: with side-seals + under-seals	T1: light			T2: medium		H: high	KGL: lithium-based grease				W2: 2 parallel axes
						P: precision	KGU: urea-based grease				W3: 3 parallel axes
							KGF: anti-fretting grease				
							GK: k-grease				
							refer to page Eng-39~				

\*The symbol for the number of axes does not mean the number of rails ordered.

part number	assembly dimensions		block dimensions											grease fitting	
	H	W	B	L <sub>1</sub>	L <sub>2</sub>	P <sub>1</sub>	P <sub>2</sub>	S	D	F	T	b	E		T <sub>1</sub>
	mm	mm	mm	mm	mm	mm	mm	mm	mm	mm	mm	mm	mm	mm	mm
<b>SGW17TE</b>	17	13.5	60	51	33.6	53	26	M4	3.3	3.2	6	14.5	2.5	4	pressed fitting
<b>SGW21TE</b>	21	15.5	68	58	40	60	29	M5	4.4	3.7	8	18		4.5	B-M6F
<b>SGW27TE</b>	27	19	80	71.8	51.8	70	40	M6	5.3	6	10	24	12	6	
<b>SGW35TE</b>	35	25.5	120	106.6	77.6	107	60	M8	6.8	8	14	31		8	

part number	standard rail length L mm										
<b>SGW17</b>	110	150	190	230	270	310	350	390	430	510	590
<b>SGW21</b>	130	180	230	280	330	380	430	480	530	630	730
<b>SGW27</b>	160	220	280	340	400	460	520	640	760	880	1,000
<b>SGW35</b>	280	360	440	520	600	680	760	920	1,080	1,240	1,400

Rails exceeding the maximum specified length may be fabricated if joints are used. Please contact NB for assistance.

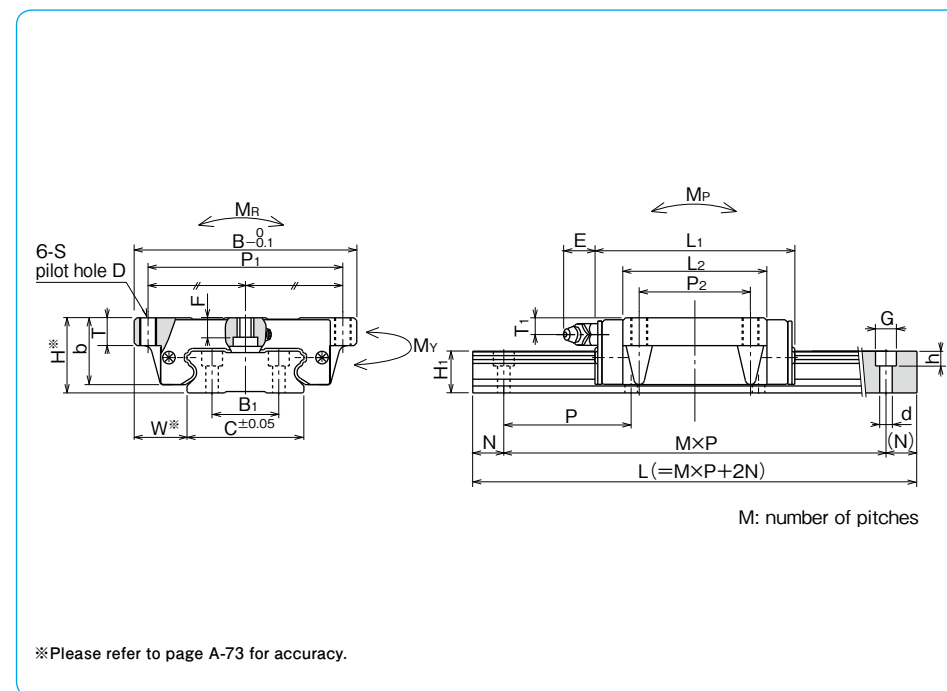

H <sub>1</sub>	C	B <sub>1</sub>	d×G×h	N	P	basic load rating		allowable static moment			mass block	mass guide rail	block size
						dynamic C	static C <sub>0</sub>	M <sub>P</sub>	M <sub>Y</sub>	M <sub>R</sub>			
mm	mm	mm	mm	mm	mm	kN	kN	N·m	N·m	N·m	kg	kg/m	
9	33	18	4.5×7.5×5.3	15	40	4.82	8.56	42.8 261	42.8 261	160	0.14	2.05	<b>17</b>
11	37	22			50	7.01	12.1	72.3 418	72.3 418	253	0.23	2.84	<b>21</b>
15	42	24	7×11×9	20	60	12.9	21.5	171 931	171 931	496	0.46	4.43	<b>27</b>
19	69	40			80	30.6	48.5	578 3,100	578 3,100	1,850	1.35	9.32	<b>35</b>

M<sub>P2</sub> and M<sub>Y2</sub> are allowable static moments when two blocks are used in close contact. 1kN≒102kgf 1N·m≒0.102kgf·m

							maximum length
							mm
670	750	830	950	1,070	1,190	1,310	2,000
830	930	1,030	1,180	1,330	1,480		2,000
1,180	1,360	1,540	1,720	1,900			3,000
1,640	1,880	2,120					3,000