

# TRK-E TYPE

– Triple-Wide Square Flange Pilot End Type –

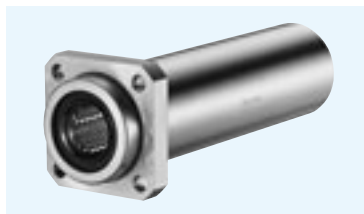

## part number structure

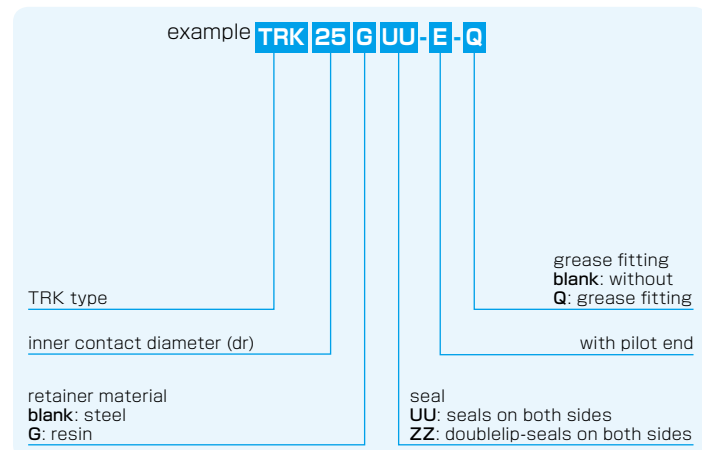

Doublelip-seal is available for size 6 to 30.

part number*		number of ball circuits	major dimensions		
steel retainer	resin retainer		dr mm	D mm	L ±0.3 mm
TRK 6UU-E	TRK 6GUU-E	4	6	15	51
TRK 8UU-E	TRK 8GUU-E	4	8	19	66
TRK 10UU-E	TRK 10GUU-E	4	10	23	80
TRK 12UU-E	TRK 12GUU-E	4	12	26	84
TRK 13UU-E	TRK 13GUU-E	4	13	28	90
TRK 16UU-E	TRK 16GUU-E	4	16	32	103
TRK 20UU-E	TRK 20GUU-E	5	20	40	118
TRK 25UU-E	TRK 25GUU-E	6	25	45	165
TRK 30UU-E	TRK 30GUU-E	6	30	52	182
TRK 35UU-E	TRK 35GUU-E	6	35	60	200
TRK 40UU-E	TRK 40GUU-E	6	40	65	230
TRK 50UU-E	TRK 50GUU-E	6	50	85	290
TRK 60UU-E	TRK 60GUU-E	6	60	100	310

Outer cylinder is treated with electroless nickel plating.

\* Seals-on-both-sides is standard.

\*\* TRK6: A-MT6x1 TRK8: A-M6x1 TRK10~30: A-M6F TRK35~60: A-R1/8

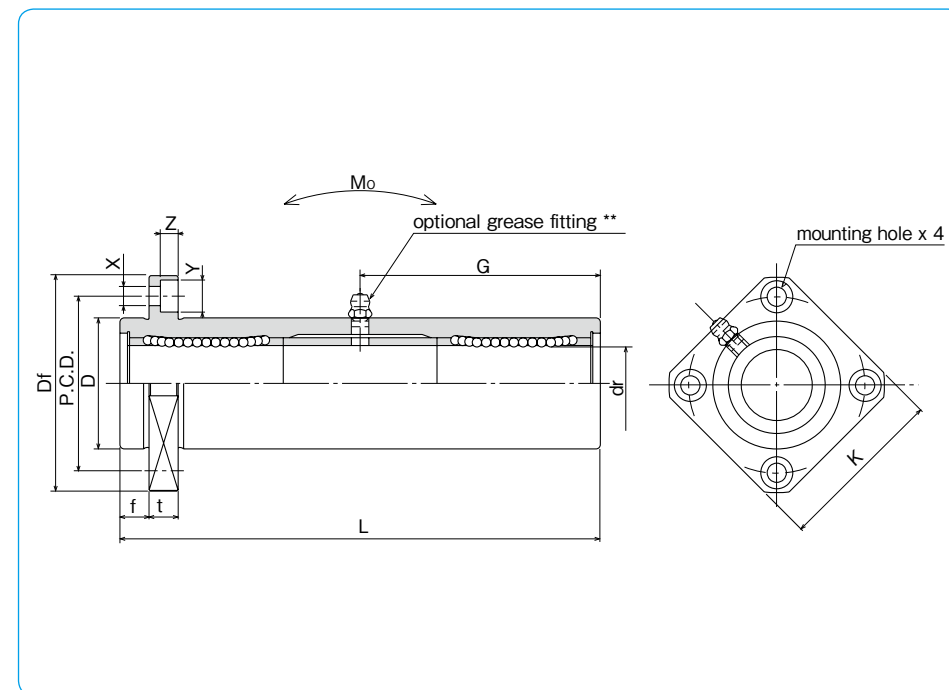

f mm	Df mm	flange			P.C.D. mm	X×Y×Z mm	grease fitting G mm	eccentricity μm	perpendicularity μm	basic load rating		allowable static moment Mo N·m	mass g	shaft diameter mm
		K mm	t mm	C N						Co N				
5	32	25	5	24	3.5×6×3.1	20.5	20	20	323	530	8.2	58	6	
6	40	30	6	29	4.5×7.5×4.1	29			431	784	16.0	117	8	
6	43	34	6	33	4.5×7.5×4.1	38			588	1,100	27.0	189	10	
6	46	35	6	36	4.5×7.5×4.1	41			813	1,570	40.1	228	12	
6	48	37	6	38	4.5×7.5×4.1	45	25	25	813	1,570	42.9	286	13	
8	54	42	8	43	5.5×9×5.1	51			1,230	2,350	73.5	376	16	
8	62	50	8	51	5.5×9×5.1	59			1,400	2,740	98.0	714	20	
10	74	58	10	60	6.6×11×6.1	82.5			1,560	3,140	157	1,163	25	
10	82	64	10	67	6.6×11×6.1	91	30	30	2,490	5,490	297	1,543	30	
13	96	75	13	78	9×14×8.1	100			2,650	6,270	373	2,400	35	
13	101	80	13	83	9×14×8.1	115			3,430	8,040	553	2,510	40	
18	129	100	18	107	11×17×11.1	145			6,080	15,900	1,370	6,400	50	
18	144	116	18	122	11×17×11.1	155	7,550	20,000	1,800	9,200	60			

1N≐0.102kgf 1N·m≐0.102kgf·m