

SM-AJ TYPE

– Clearance Adjustable Type –



part number structure

example **SMS 25 G UU -AJ**

specification
SM: standard
SMS: anti-corrosion

inner contact diameter (dr)

retainer material
blank: standard/steel
U: anti-corrosion/stainless steel
G: resin

clearance-adjustable

seal
blank: without seal
U: seal on one side
UU: seals on both sides

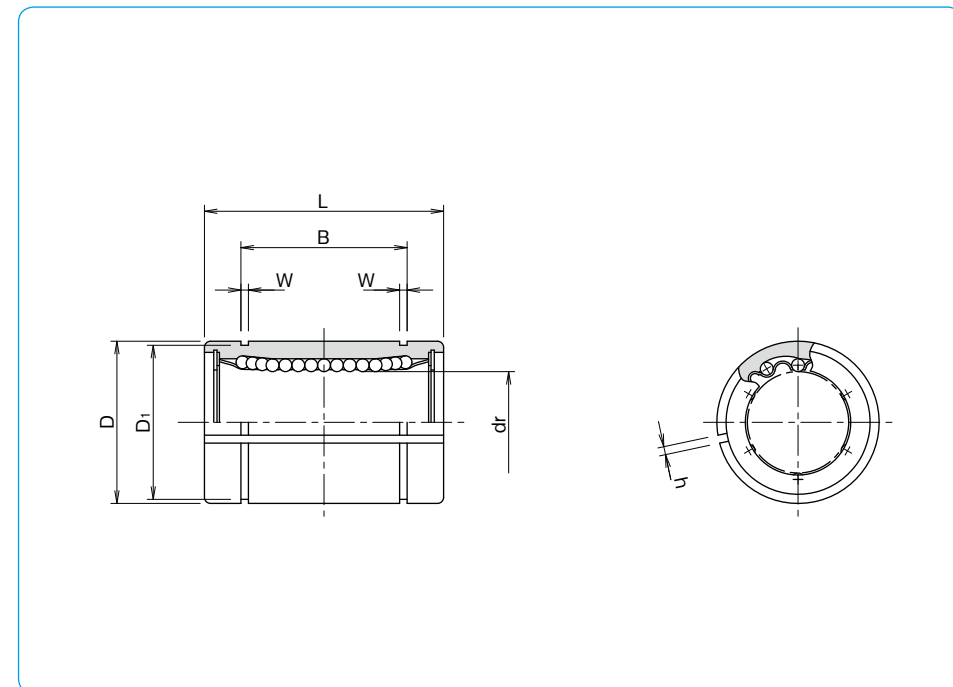

part number		number of ball circuits	dr	major dimensions			
standard	anti-corrosion			D	D		
steel retainer	resin retainer	stainless retainer	resin retainer	mm	tolerance* μm	mm	tolerance* μm
—	SM 6G-AJ	—	SMS 6G-AJ	4	6	12	0
—	SM 8sG-AJ	—	SMS 8sG-AJ	4	8	15	-11
—	SM 8G-AJ	—	SMS 8G-AJ	4	8	15	0
—	SM10G-AJ	—	SMS10G-AJ	4	10	19	-9
SM 12-AJ	SM12G-AJ	SMS 12-AJ	SMS12G-AJ	4	12	21	0
SM 13-AJ	SM13G-AJ	SMS 13-AJ	SMS13G-AJ	4	13	23	-13
SM 16-AJ	SM16G-AJ	SMS 16-AJ	SMS16G-AJ	4	16	28	0
SM 20-AJ	SM20G-AJ	SMS20-AJ	SMS20G-AJ	5	20	32	0
SM 25-AJ	SM25G-AJ	SMS25-AJ	SMS25G-AJ	6	25	40	-16
SM 30-AJ	SM30G-AJ	SMS30-AJ	SMS30G-AJ	6	30	45	0
SM 35-AJ	SM35G-AJ	SMS35-AJ	SMS35G-AJ	6	35	52	0
SM 40-AJ	SM40G-AJ	SMS40-AJ	SMS40G-AJ	6	40	60	-19
SM 50-AJ	SM50G-AJ	SMS50-AJ	SMS50G-AJ	6	50	80	0
SM 60-AJ	SM60G-AJ	SMS60-AJ	SMS60G-AJ	6	60	90	0
SM 80-AJ	SM80G-AJ	—	—	6	80	120	-22
SM100-AJ	—	—	—	6	100	150	0
SM120-AJ	—	—	—	8	120	180	-25
SM150-AJ	—	—	—	8	150	210	0/-29

* Accuracy is measured prior to machining clearance slit.

mm	L tolerance mm	B tolerance mm	W mm	D ₁ mm	h mm	eccentricity* μm	basic load rating		mass g	shaft diameter mm	
							dynamic C N	static C ₀ N			
19	0 -0.2	13.5	0 -0.2	1.1	11.5	12	206	265	7.5	6	
17		11.5		1.1	14.3		1	176	216	10	8
24		17.5		1.1	14.3		1	274	392	14.7	8
29		22		1.3	18		1	372	549	29	10
30		23		1.3	20		1.5	510	784	41	12
32		23		1.3	22		1.5	510	784	48	13
37	0 -0.3	26.5	0 -0.3	1.6	27	20	774	1,180	75	16	
42		30.5		1.6	30.5		1.5	882	1,370	98	20
59		41		1.85	38		2	980	1,570	237	25
64		44.5		1.85	43		2.5	1,570	2,740	262	30
70		49.5		2.1	49		2.5	1,670	3,140	420	35
80		60.5		2.1	57		3	2,160	4,020	640	40
100	0 -0.4	74	0 -0.4	2.6	76.5	25	3,820	7,940	1,680	50	
110		85		3.15	86.5		3	4,700	10,000	1,980	60
140		105.5		4.15	116		3	7,350	16,000	4,400	80
175		125.5		4.15	145		3	14,100	34,800	8,540	100
200		158.6		4.15	175		3	16,400	40,000	14,900	120
240		170.6		5.15	204		3	21,100	54,300	20,150	150

1N≒0.102kgf