

# SYBS TYPE

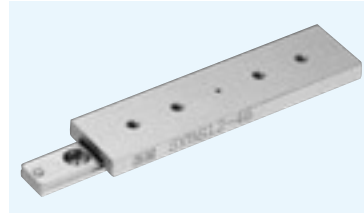

## part number structure

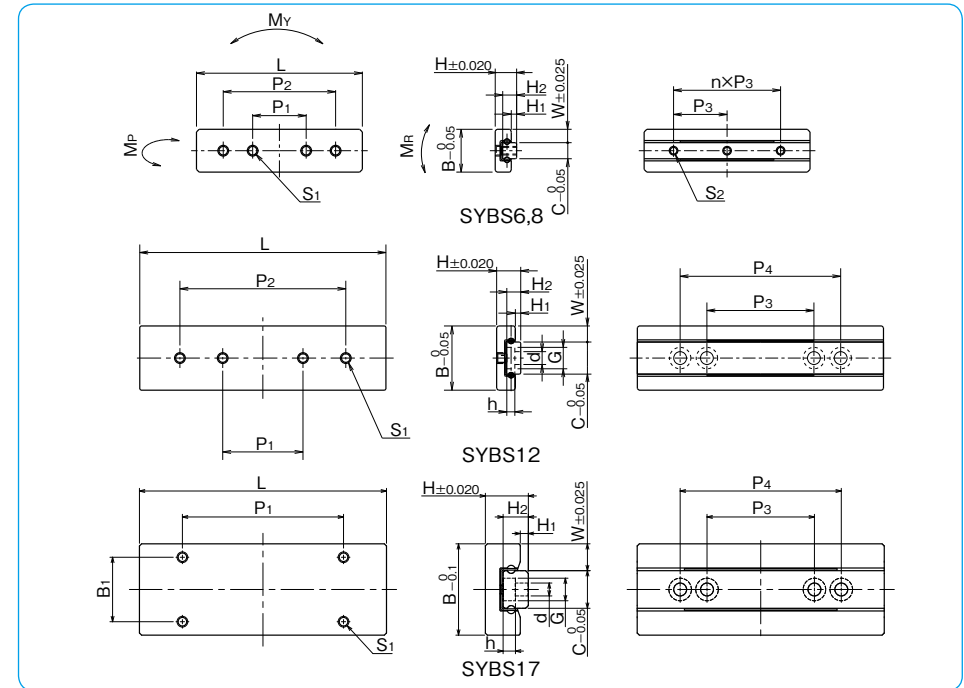
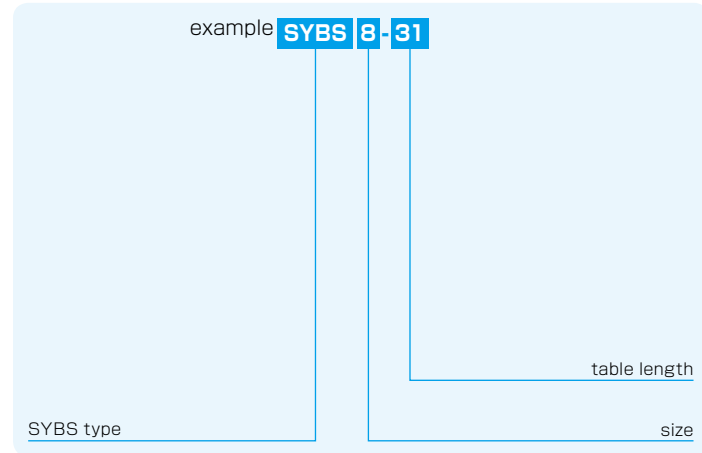

part number	major dimensions				tabel-top dimensions						S <sub>1</sub> maximum screw penetration depth mm
	H mm	W mm	H <sub>1</sub> mm	stroke mm	B mm	L mm	P <sub>1</sub> mm	P <sub>2</sub> mm	B <sub>1</sub> mm		
<b>SYBS 6-13</b>	3.2	2	0.7	5	6	13	6.0	—	—	M1.4	0.5
<b>SYBS 6-21</b>				12		21	10.0	—	—		
<b>SYBS 8-11</b>	4	2.5	1	4	8	11	5.5	—	—	0.7	
<b>SYBS 8-21</b>				12		21	10.0	—	—		
<b>SYBS 8-31</b>				18		31	10.0	21	—		
<b>SYBS12-23</b>	4.5	3	1	12	12	23	8.0	—	—	M2	1.2
<b>SYBS12-31</b>				18		31	15.0	—	—		
<b>SYBS12-46</b>				28		46	15.0	31	—		
<b>SYBS17-23</b>	8	5	1.5	14	17	23	10.0	—	—	12	3
<b>SYBS17-31</b>				19		31	20.0	—	—		
<b>SYBS17-46</b>				29		46	30.0	—	—		

※1: Custom mounting screws are provided with the SYBS-12 type only. Other screw sizes are also available. (Please refer to page G-53)

H <sub>2</sub> mm	C mm	bed-surface dimensions				basic load rating		allowable load F N	allowable static moment			mass g	size	
		d×G×h mm	S <sub>2</sub>	P <sub>3</sub> mm	n mm	P <sub>4</sub> mm	dynamic C N		static C <sub>0</sub> N	M <sub>P</sub> N·m	M <sub>Y</sub> N·m			M <sub>R</sub> N·m
2.0	2	—	M1	7	1	—	154	180	60.1	0.21	0.25	0.21	1.4	<b>6-13</b>
				7	2	—	229	315	105	0.57	0.69	0.37	2.2	<b>6-21</b>
2.6	3	—	M1.6	5	1	—	201	211	70.4	0.23	0.28	0.35	2.0	<b>8-11</b>
				10	1	—	368	493	164	1.02	1.22	0.83	3.7	<b>8-21</b>
2.6	6	※1 2.4×4×1.5	—	15	—	—	404	563	187	1.30	1.55	1.80	7.6	<b>12-23</b>
				15	—	—	473	704	234	1.97	2.35	2.25	10.2	<b>12-31</b>
				20	—	30	658	1,120	375	4.80	5.72	3.60	15.2	<b>12-46</b>
				15	—	—	775	888	296	2.09	2.49	3.33	19.2	<b>17-23</b>
4.7	7	2.4×4.2×2.3	—	15	—	—	984	1,240	414	3.80	4.53	4.66	26.2	<b>17-31</b>
				20	—	30	1,350	1,950	651	8.75	10.4	7.32	38.4	<b>17-46</b>

1N≒0.102kgf 1N·m≒0.102kgf·m