

H-TA type

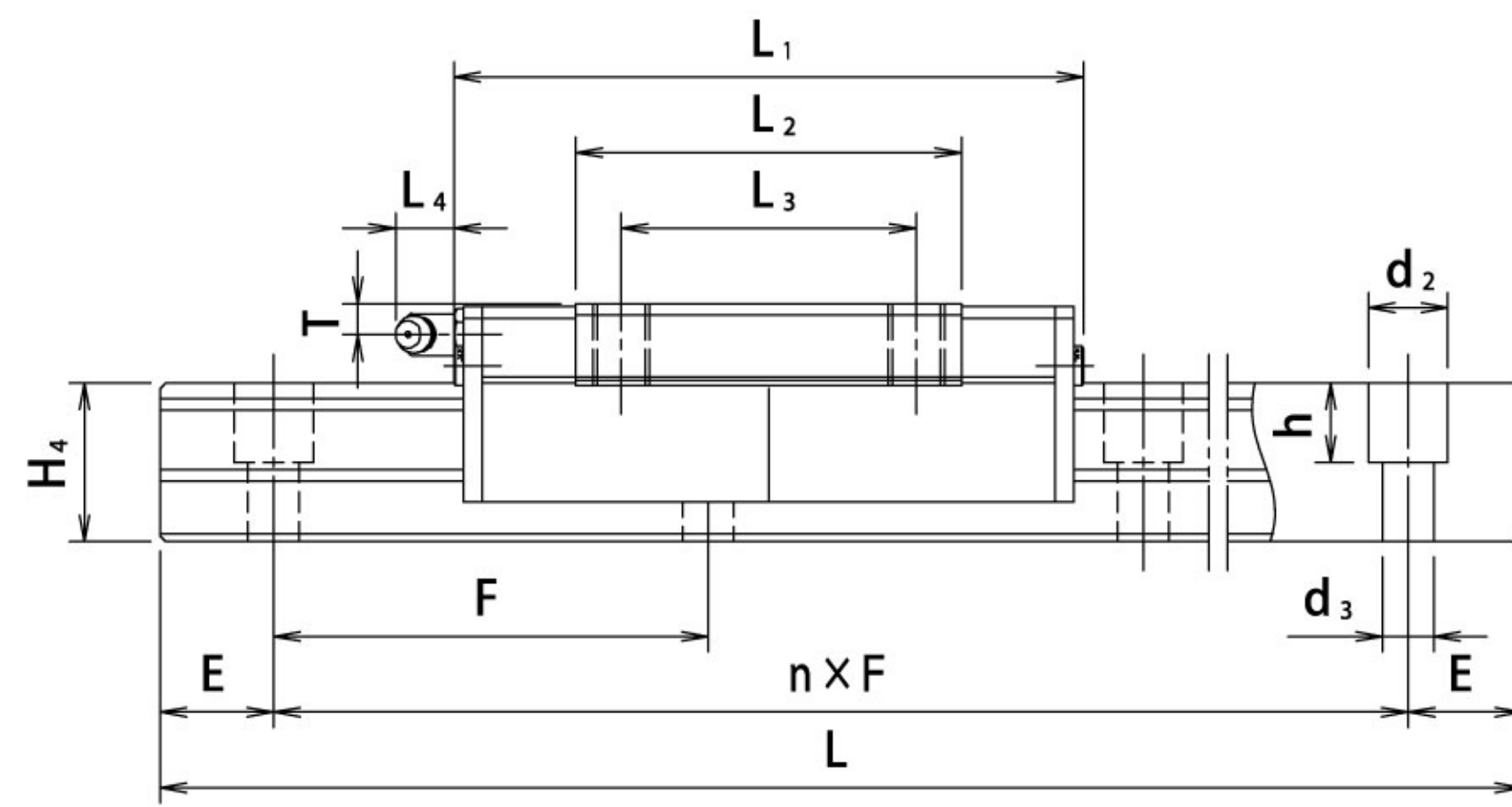
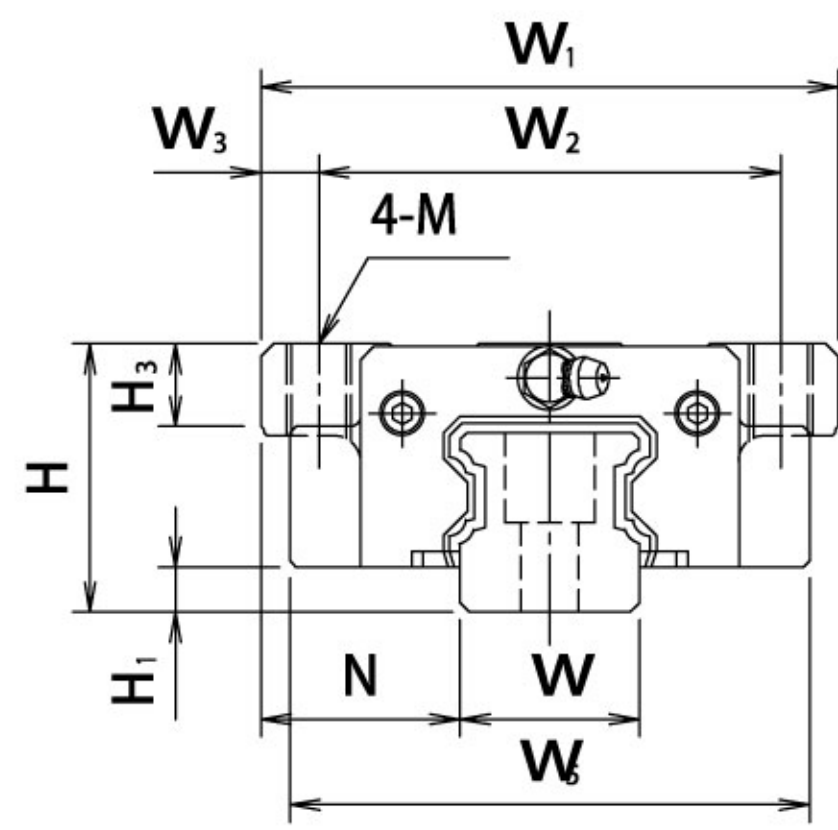

Type **H30TA** **B2** **T1** - **2000** **C5** **W2** - **123** /**AFB**

Nominal Type No

Numbers of slide units used on the same rail
B1= 1 slide, B2= 2 slides ...

Preload symbol Select from T ~ T3

Total length of rail

Accuracy symbol Select from C001 ~ C7

Numbers of rails used on the same plane W1= 1 rail, W2= 2 rails ...

Special symbol

1. Special work is needed for the rail
2. Special work is needed for the slide unit
3. Special specification except from above 1 and 2

Supplementary symbol

- A. Joint specification with the multiple rails
- F. Plug for the rail mounting hole
- B. Attaching the bellows

In case of special and supplementary symbol is not necessary, it's not expressed in ,
Please refer to page C4 for the designation of a single rail or a single slide unit

Type No.	Assembly dimensions (mm)			Slide unit dimensions (mm)												
	Height		Width	Width	Pitch	Pitch	Pitch	Length	Pitch	Pitch	Pitch	Mounting hole		Grease nipple		
	H	H ₁	N									W ₁	W ₂	W ₃	W ₅	L ₁
H15TA	24	4.6	16	47	38	4.5	46.5	72	41	30	7	M5×7	NAS516-1A	3	0	
H20TA	30	5	21.5	63	53	5	60	92	58	40	8	M6×10	NAS516-1A	4.5	0	
H25TA	36	6.5	23.5	70	57	6.5	66	98	59	45	10	M8×12	B-M6F	5.5	10	
H30TA	42	7	31	90	72	9	81	112	68	52	13	M10×14	B-M6F	5.5	10	
H35TA	48	8	33	100	82	9	92	129	80	62	13	M10×16	B-M6F	6	10	
H45TA	60	11	37.5	120	100	10	112	159	102	80	15	M12×19	B-M6F	7	12	
H55TA	70	14	43.5	140	116	12	130	191	124	95	17	M14×23	B-PT1/8	10	12	
H65TA	85	14	53.5	170	142	14	162	227	148	110	20	M16×29	B-PT1/8	13	12	
H65TAH	90											M16×34				

Note: Please do not exceed the screw depth of the mounting hole when the mounting bolt is screwed into the slide unit.

Rail dimensions (mm)							Basic rated dynamic load		Static load	Static moment		Mass	
Width	Height	Mounting hole			Recommendation	Pitch	C ₅₀	C ₁₀₀	C ₀	M _A ·M _B	M _c	Slide unit	Rail
		d ₂	d ₃	h			E	F		(N)	(N)		
15	17	7.5	4.5	7	20	60	8834	7012	17020	117	180	0.22	1.7
20	21	9.5	6	11	20	60	15820	12560	31020	308	428	0.48	2.8
23	24	11	7	11	20	60	20950	16630	38290	395	614	0.68	3.6
28	28	14	9	14	20	80	29100	23100	52110	627	1003	1.2	5.1
34	32	14	9	14	20	80	38730	30740	68060	936	1576	1.8	7.3
45	42	20	14	21	22.5	105	62380	49510	106300	1829	3201	3.2	12.6
53	48	23	16	24	30	120	97120	77090	165900	3687	5873	5.1	17.1
63	58	26	18	25	35	150	148000	117500	239300	6173	10280	9.6 10.6	24.6

